

2-in-1

corpos

www.corpos.dk

RECHARGEABLE
callus remover



Read this booklet thoroughly before using and save it for future reference

Product Introduction

English

Congratulations on your purchase! This Rechargeable Callus Remover is an innovative device created to smooth dry, rough and calloused skin on the feet. unique rollers grinding spins 360 degrees, at an amazing 40 times a second, 300 degrees wide angle to gently and effectively buff away hard, jagged skin on the heels. This Callous Remover works faster and is safer than metal scrapers, with no blades to cut the skin, and easier to use than other methods, that require constant rubbing to achieve results, it is battery-operated and designed to fit comfortably in your hands, smooth, silky feet has never been easier.

This Callous Remover is recommended for one person only, for hygienic reasons, unique rollers grinding should not be shared with others.

General descriptions

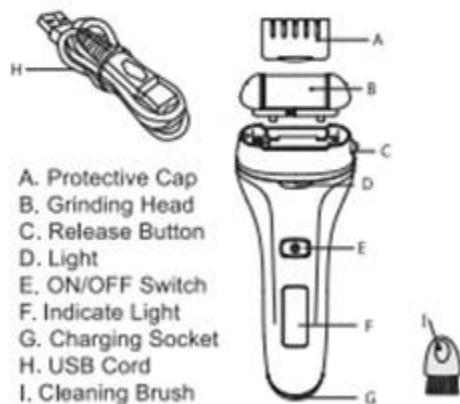

- A. Protective Cap
- B. Grinding Head
- C. Release Button
- D. Light
- E. ON/OFF Switch
- F. Indicate Light
- G. Charging Socket
- H. USB Cord
- I. Cleaning Brush

Matters needing attention

1. The Callous Remover is only for use on the feet and heels. Do not use this device anywhere else on the body.
2. Use the Callous Remover only for purposes described in this instruction book.
3. Each head is recommended for one person only. For hygienic reason, the head should not be shared with others.
4. Do not use if you have diabetes or poor blood circulation.
5. If you have any skin conditions or other medical issues, please consult with your physician prior to use.
6. Do not use on skin for more than 2-3 seconds at a time.
7. Do not use on skin that is red, irritated, inflamed, infected or blistered.
8. Do not use on warts, on sores or open wounds.
9. Discontinue use immediately if you experience any pain or irritation.
10. Overuse may cause skin irritation.
11. Seek medical attention if skin becomes severely irritated or bleeds.
12. Household use only.
13. This appliance is not intended for use by persons (including children) with reduced physical, sensory or mental capabilities, or lack of experience and knowledge, unless they have been given supervision or instruction concerning the use of the appliance by a person responsible for their Safety. **Warning/Important**
14. Do not place or store your unit in direct sunlight. please store your unit in at a cool dry place at a temperature between 0-40°C. Keep the appliance dry, when it is not in use.

15. Do not turn your unit On if the Rollers Grinding head is not attached.
16. Do not drop or insert anything into any opening of the unit.
17. Do not use your unit outdoors.
18. Children should be supervised to ensure that they do not play with this appliance.
19. Keep your unit out of reach of children as it is not intended for use by children.
20. This appliance is not to be used on, by or near children or invalids.
21. To prevent accidents and injury to you or damage to the unit -when your Callous Remover is in use, keep it away from the hair on your scalp, your eyebrows, eyelashes as well as clothes, brushes wires, cords, shoelaces, etc.
22. Do not continually rub the unit on the same area or apply strong pressure.
23. Keep the protective cover on your unit when it is not in use.
24. Do not disassemble this device
25. Products regularly charging time for 3.5 hours.

Charging Instruction

1. Make sure the switch is off.
2. Plug the power cord into the charging jack of the footer. (plug groove facing up)
3. Plug the USB port into the charging treasure, computer interface or power connector.
4. When charging, the digital screen lights up and the charging plug icon appears, indicating that it is charging, and the battery display number ranges from 001 to 100.
5. The charging time of this product is about 3.5 hours. When fully charged, the digital screen shows 100 to

indicate that the charging is complete.

6. Before using this product, or if it has not been used for a long time, (When the power is less than 20 when the power is turned on, it means that the remaining power is insufficient. You should replenish the power before using the digital display at 100)



How to use the Callus Remover

This Callous Remover is designed for smoothing coarse skin on the feet and heels. Do not use this device anywhere else on the body.

1. Wash and clean the skin and dry fully. Note : Do not use on broken or bleeding skin.
2. Make sure the Rollers Grinding Head is placed into the unit. See section of Changing the Rollers Grinding Head on how to remove and replace head.
3. Remove the protective cover from the unit and it is ready to Use.
4. Press the start button to turn on machine (fig.3). The machine is with 2 speeds. Press once it is low speed, press one more time will change into high speed. Or when turn on machine press twice it will be high speed.
5. Gently rotate (back and forth or side to side) (fig.4) the callous/corn/hard skin area for 2-3 seconds. Do not press hard-gently glide the unit over desire area. The unit will stop if it is press too hard on the skin.

Stop and check if you have achieved the softness you desire. If not, go over the area for 2-3 more seconds and check again. Continue to use this method until the level of smoothness is obtained.

Warning: stop using if skin becomes sore or Inflamed.

Warning: Do not use on skin for more than 2-3 seconds at a time.

6. Turn the unit off (fig.5). (press once or twice to see the roller stop running then is shut off)

7. Rinse the skin or use a wet towel to get rid of the excess dead particles.

8. To clean this Callous Remover, please see the Cleaning section.

9. Keep the protective cover on your unit when it is not in use.



Changing the Rollers Grinding Head

Change the Rollers Grinding Head as needed for best result. the Rollers Grinding Head last for a few sessions depending on frequency of use and size of area being treated. Replace as needed. Make sure the unit is turned off before replacing the Rollers Grinding Head.

1. One hand hold the head, another hand press in the release button, on the side of the unit, the head will tack out (fig. 6 & 7).

2. Place a new Rollers Grinding Head into the unit

until you hear a "click" sound. Be sure to insert the new head into the unit, it has been firmly installed. Changing the Rollers Grinding Head
Note: Do not turn your unit On if the Rollers Grinding head is not attached.

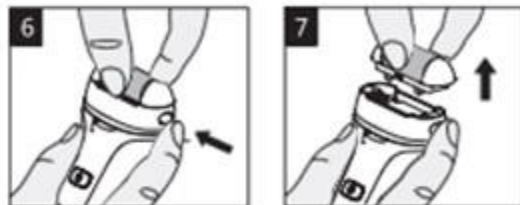

Note: When opening the product packaging, the machine has been installed with a coarse sanding head, and there is a spare grinding head in the box as a fine sanding head.

How to Cleaning

Note: Clean the appliance after each use to ensure better performance

This Callous Remover is water resistant It can be rinsed under water for cleaning:

1. Remove the protective cover from the head.

2. Clean the Callous Remover with the cleaning brush. Do not switch the appliance on while brushing (fig. 8).

3. Rinse the unit under the tap. sometime you can operate the unit, keep the head running for 5~10 seconds, that quick and high efficiency (fig. 9).

4. Turn the unit off.

5. Wipe the body of the unit with a clean dry cloth.

6. Replace the protective cover.



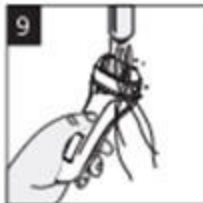

Storage

When the appliance is not in use, put it on a dry place that children can not touch.
Do not place the appliance in an area with excessive heat or moisture